

# Flat

5924

Design By Ichiro Iwasaki

Flat is a large ceiling lamp made up of horizontal discs at various heights that create planes of reflected light. The discs are self-illuminated by reflected light. The Flat ceiling light has a strong graphic quality, combining structure and functionality.

VIBIA

## Model Sheet

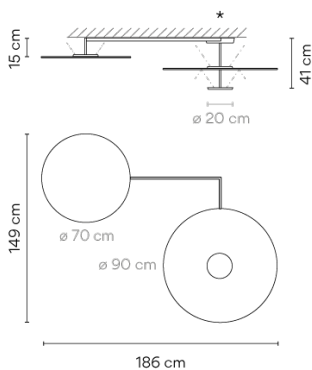

### Finish

- 73 White, Grey L1  
NCS S 0300-N, NCS S 1000-N
- 10 White  
NCS S 0300-N
- 72 White, Green L1  
NCS S 0300-N, NCS S 4005-G80Y

### LED temperature color

2700 K / 3500 K

### Dimming

Push; 1-10V; DALI / Casambi

### Installation type

Surface Canopy

### Materials

Ceiling rose: Steel  
Reflector: Aluminum  
Body: Steel  
Head: Aluminium

### Light source

3 x LED PLATE 25W 700mA



### LED

CRI>90 10440 lm 139.20  
2700 K / 3500 K

### Driver

Constant Current 700 110~240  
V V 50~60 Hz HZ



### Application

Ceiling Lamps

### Packaging

1 Box  
1.275 m x 1.06 m x 0.46 m  
Gross weight 62  
Net weight 19.98  
Vol. 0.6216

### Lighting effect

#### General Lighting

Lamp that emits an upward or backward beam that is reflected by the ceiling or wall.

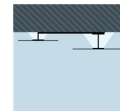

### Photometric Data

Efficiency	88.00 lm/W
Coordinate System	CG
Total Flux	7154.22 lm
Maximum Value	2122.35 cd

### Other Applications

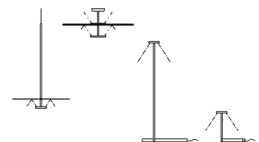

All of our products come with a five-year warranty. Check our legal terms at [www.vibia.com/warranty](http://www.vibia.com/warranty)

Vibia Lighting, S.L.U.

Office / Oficina  
Progrés 4-6. 08850 Gavà. Barcelona, Spain.

International T +34 934 796 971  
Spain / Portugal T +34 934 796 970

customer.service@vibia.com  
vibia.com