

HAZE WALL CABINET

ASSEMBLY MANUAL

fermliving.com

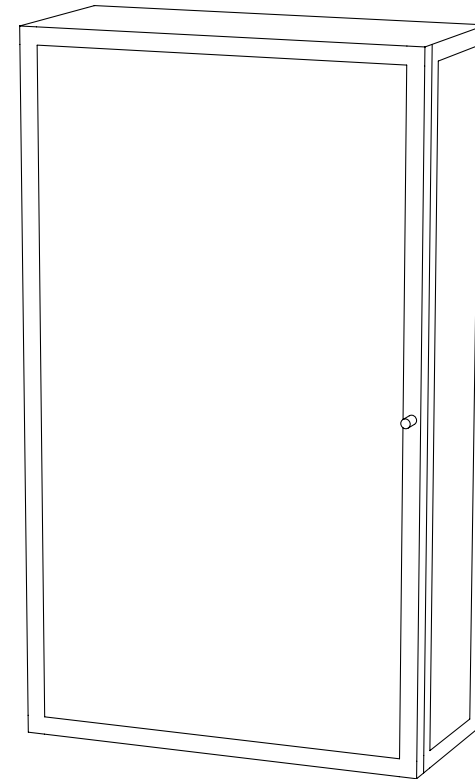

ferm
LIVING

CONTENT OF THE BOX

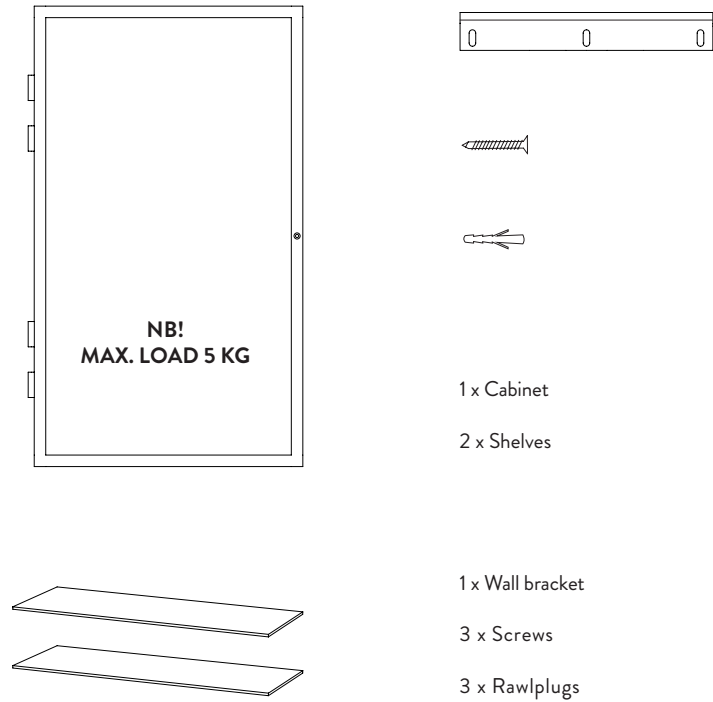

NOTE:

Please note to check that the screws included can be used for your type of wall.
Different walls requires different type of tools.

ASSEMBLY PROCESS

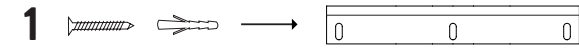

Mount the wall bracket to the wall by drilling the 3 holes and inserting the rawlplugs and screws.

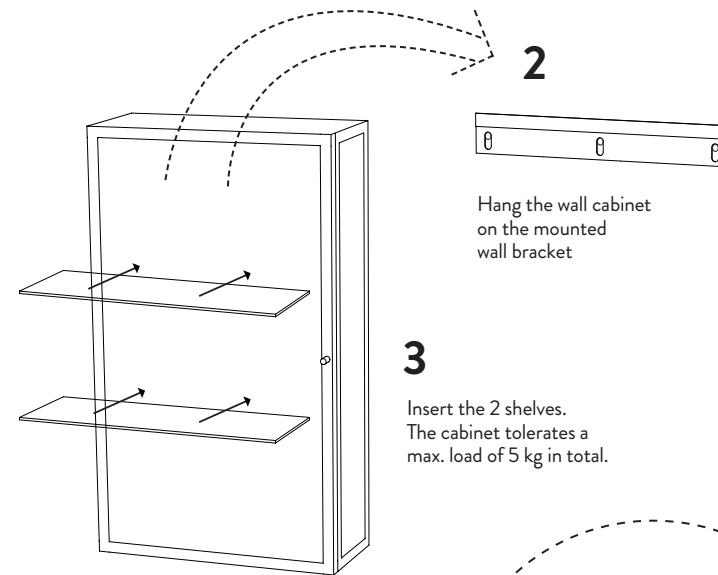

Hang the wall cabinet on the mounted wall bracket

3

Insert the 2 shelves. The cabinet tolerates a max. load of 5 kg in total.

NB:

To make the cabinet open from the opposite side:
Flip the wall cabinet 'upside down' and hang it on the wall bracket.

