

Gooseneck Bianca / Emma / Olga

Installation instructions

GENERAL INFORMATION

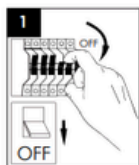

- Before any work turn off the mains supply.
- Installation should only be carried out by a qualified electrician, who should be aware of the current Regulations on Internal & External Installations.
- In case of glass breakage, replace immediately.
- Lightbulb Wattage should never exceed the Wattage (W) indicated on the label or the packaging of the light fixture.
- The product should be connected to a line protected by a differential current circuit, while the nominal persistent operating current should not exceed 30mA (leakage relay).

LIGHT FIXTURE INSTALLATION

1. MOUNTING THE LIGHT FIXTURE

- Using the base of the light fixture as an installation guide, mark the surface on which you wish to mount it.
- Drill holes on the mounting surface and insert the wall-plugs.
- Insert the stainless steel hex head M5 screws into the back plate.
- Pass the supply cable through the back plate using the supplied rubber inlet.
- Screw the back plate on the mounting surface with the supplied screws.
- Attach the terminal block to the back plate.
- Connect the power cable and the light fixture cable wires to the terminal block, using the L (Line: Brown wire), N (Neutral: Blue wire) and Grounding: Yellow wire) \perp symbols as reference.
- Place the fixture on the back plate and fasten it, screwing the M5 brass blind nuts by hand onto the stainless M5 hex head screws. Fasten them in place, using a wrench. 1 full 360° revolution of the wrench is enough.
- Unscrew the cage and remove the glass of the light fixture.
- Screw the lightbulb into the lamp holder.
- Replace the glass and screw the cage and screw the cage on the body of the light fixture.
- Turn on the power supply

2. REPLACING THE LIGHTBULB

- Turn off the mains supply.
- Do not try to replace the lightbulb unless it has completely cooled down as it may cause serious burns on the skin.
- Open the lightbulb's cover.
- Twist and pull the lightbulb gently.
- Do not touch the lightbulb with bare hands.
- Always use clean protective gloves when handling a lightbulb.
- Use a clean towel to clean the lightbulb in case you touch it accidentally.
- When replacing the lightbulb, twist it very carefully while the lightbulb is still in the lampholder.
- Before turning on the power supply again, replace the lightbulb's cover to maintain the impermeability of the fixture.

The manufacturer bears no responsibility for any injury or damage resulting from incorrect installation or use of the product