

Wall Square One / Wall Square Two

Installation instructions

GENERAL INFORMATION

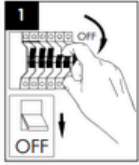

- Before any work turn off the mains supply.
- Installation should only be carried out by a qualified electrician, who should be aware of the current Regulations on Internal & External Installations.
- In case of glass breakage, replace immediately.
- Lightbulb Wattage should never exceed the Wattage (W) indicated on the label or the packaging of the light fixture.
- The product should be connected to a line protected by a differential current circuit, while the nominal persistent operating current should not exceed 30mA (leakage relay).

LIGHT FIXTURE INSTALLATION

1. MOUNTING THE LIGHT FIXTURE

- Unscrew the cage and remove the glass from the base of the light fixture.
- Using the base of the light fixture as an installation guide, mark the surface on which you wish to mount it.
- Drill holes on the mounting surface and insert the wall-plugs.
- Place the rubber cable inlet to the light fixture's base.
- Screw the base of the light fixture onto the mounting surface. To ensure the insulation of the light fixture, use the plastic washers and rubber retainers when screwing the screws.

2. CONNECTING THE POWER CABLE

- Pass the power cable through the rubber inlet.
- Cover the wires with the supplied insulating hoses. Connect the line (brown) and neutral (blue) wires to the porcelain terminal block, using the L & N symbols as reference. Connect the grounding wire (yellow) to the base of the light fixture next to the grounding symbol \perp , using the supplied screw and M4 washer.
- Screw the lamp to the lamp holder.
- Fit the glass and fasten the cage to the body of the light fixture.
- Turn on the power supply.

3. REPLACING THE LIGHTBULB

- Turn off the mains supply.
- Do not try to replace the lightbulb unless it has completely cooled down as it may cause serious burns on the skin.
- Open the lightbulb's cover.
- Twist and pull the lightbulb gently.
- Do not touch the lightbulb with bare hands.
- Always use clean protective gloves when handling a lightbulb.
- Use a clean towel to clean the lightbulb in case you touch it accidentally.
- When replacing the lightbulb, twist it very carefully while the lightbulb is still in the lampholder.
- Before turning on the power supply again, replace the lightbulb's cover to maintain the impermeability of the fixture.

The manufacturer bears no responsibility for any injury or damage resulting from incorrect installation or use of the product