

instruction manual

tramonto 05

valerie_objects

V9022104 > tramonto 05/mirror finish

V9022105 > tramonto 05/laquer finish

luminaire specs

TYPE wall lamp

SWITCH remote dimmable handswitch

BULB led strip 8 watt/meter - 2500lm- cri95

IP 20

plug (Type F) for wall socket connection

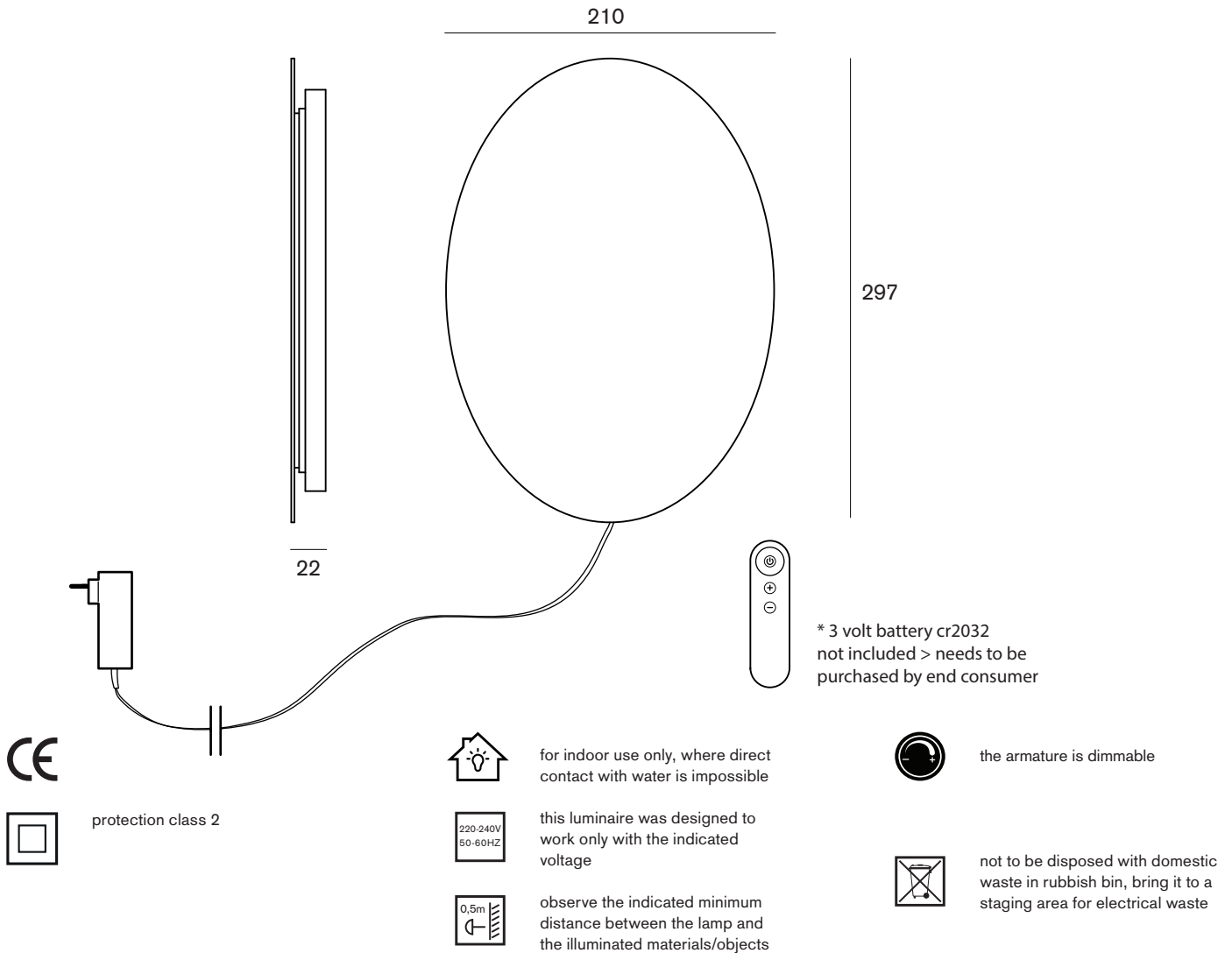

safety directions

Please read the instruction manual carefully before installing or using this product.

Keep this user manual for further reference / two persons needed for installation.

1. The luminaires may only be installed by authorized and qualified technicians according valid regulations for electrical installation.
2. Maintenance of the luminaires is limited to their surfaces. During maintenance no moisture should come into contact with any areas of the terminal connections or voltage control parts.
3. Take account of the minimal separation distance from other objects and the room required around the fitting.
4. If in any doubt, consult a professional, taking local installation requirements into account. Some countries stipulate that lighting may be installed only by registered installers.
5. Clean with a clean, dry cloth or brush, use no solvents or abrasives. Avoid dampness on all electrical components.
6. Take account of all available technical information.
7. If the external flexible cable or cord of this luminaire is damaged, it shall be exclusively replaced by the manufacturer or his service agent or a similar qualified person in order to avoid a hazard.

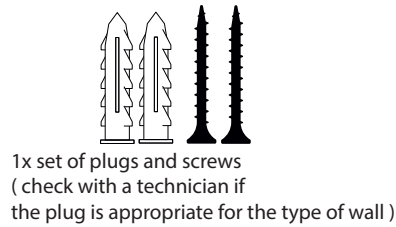
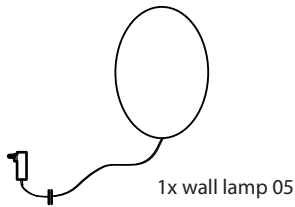

*** determine the preferred position of your Tramonto wall lamp 05**

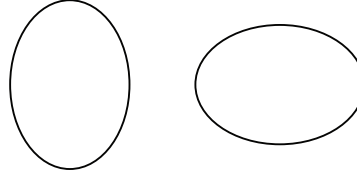

*** drill 2 connection holes > follow indicated grid**

- > advised to be installed by a technician
- > use the correct plug for the type of wall
- > respect the drill diameter indicated on the plug

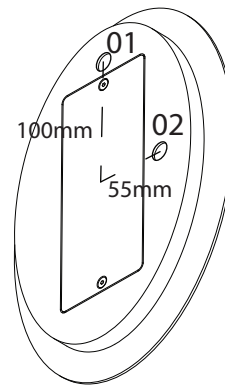

*** secure the cable at the backside**

- > depending on the positioning of the Tramonti wall lamp the preferred cable outlet point needs to be fixed using a simple household tape at the back side

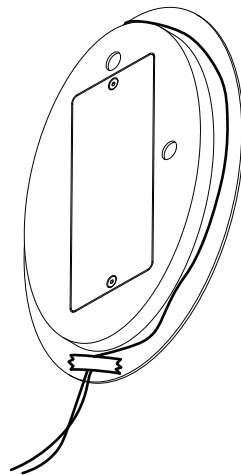

*** activate the remote control**

step **01** / activate remote control by inserting the requested 3 volt battery type cr2032 (battery not included in packaging)

step **02** / plug the lamp in the wall socket (compatible with plug type F)

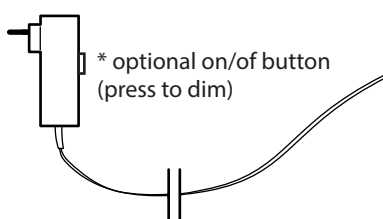

step **03** / the first 10 seconds push from top to down 1 > 2 > 3 on the remote control.

A blinking signal indicates the lamp is connected with the remote control.

