

IMPORTANT!

It is crucial to turn off the power to the circuit prior to commencing any installation work. In certain nations, installation work related to electricity may solely be performed by an authorized electrical contractor. For guidance, reach out to your local electricity authority.

Please visit Nordic-tales.com for more technical information or contact customerservice@nordic-tales.com

NORDIC TALES
TOP FLOOR
BRAMMERSGADE 6
AARHUS
DENMARK



NORDIC TALES
SCANDINAVIAN DESIGN TRADITIONS

Assembly Instructions
NAUTICO

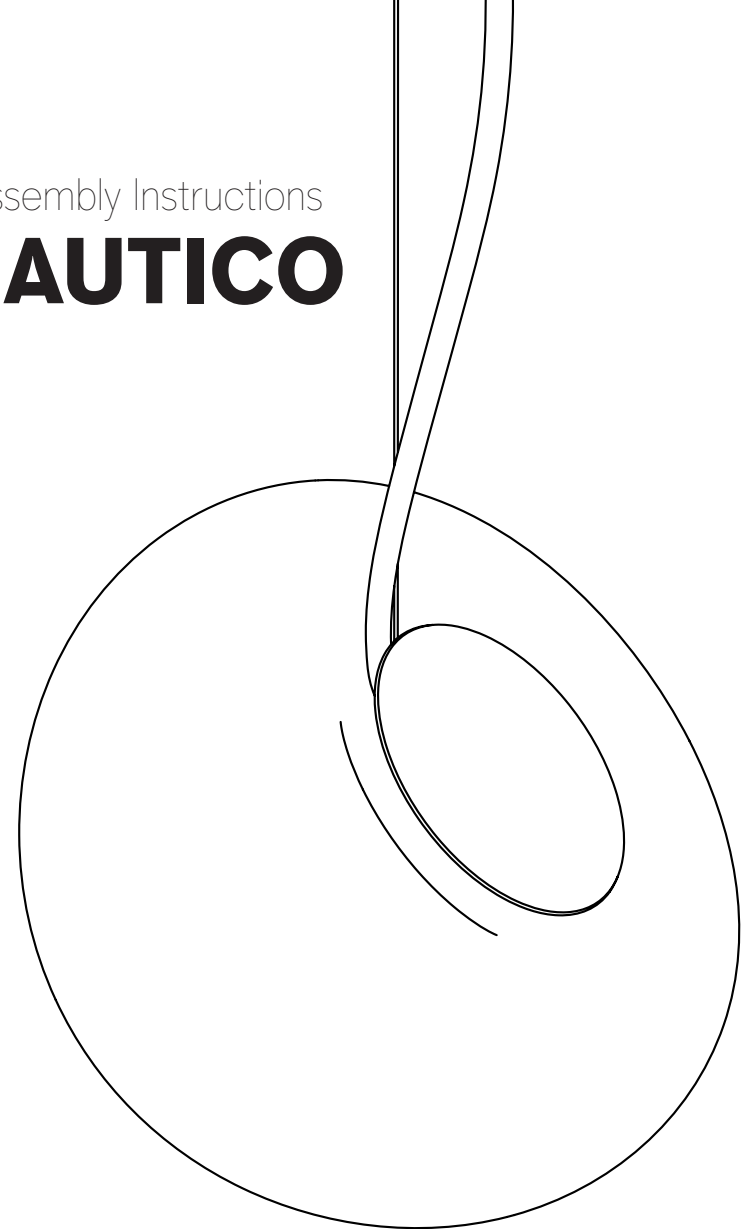

NORDIC TALES
SCANDINAVIAN DESIGN TRADITIONS

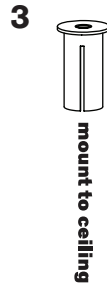
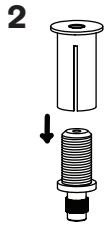
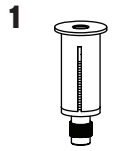

IMPORTANT!
Make sure to use
a screw that is compliant
with your ceiling

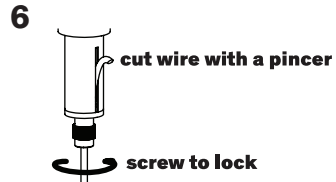
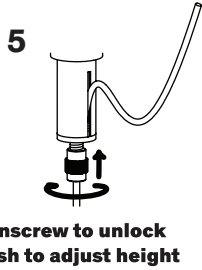
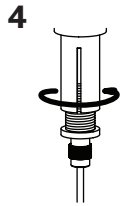

unscrew to unlock
push to adjust height

cut wire with a pincer
screw to lock

7

Rotate 20 degrees
and eject the
sealing lid.

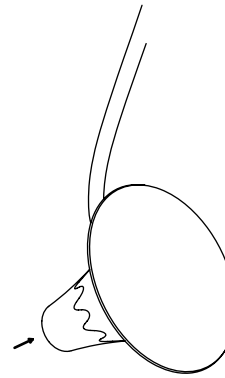
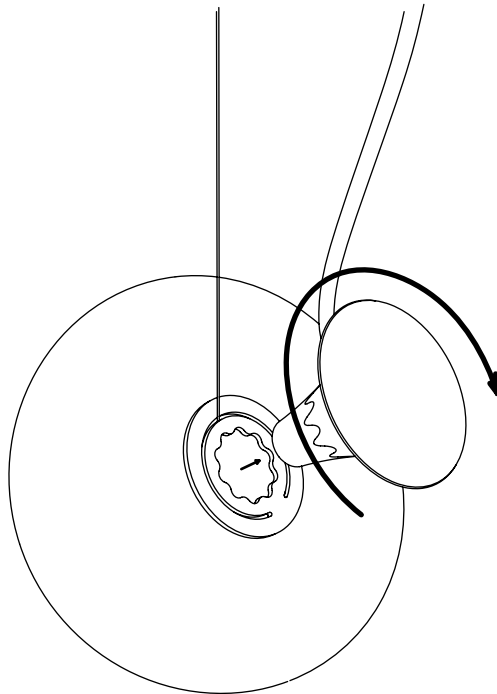

8
Insert G9 Bulb
NB! Max 5 Watt

220-240V-50Hz, G9 Max 5 Watt

9

Insert sealing lid
and rotate 20
degrees to lock.

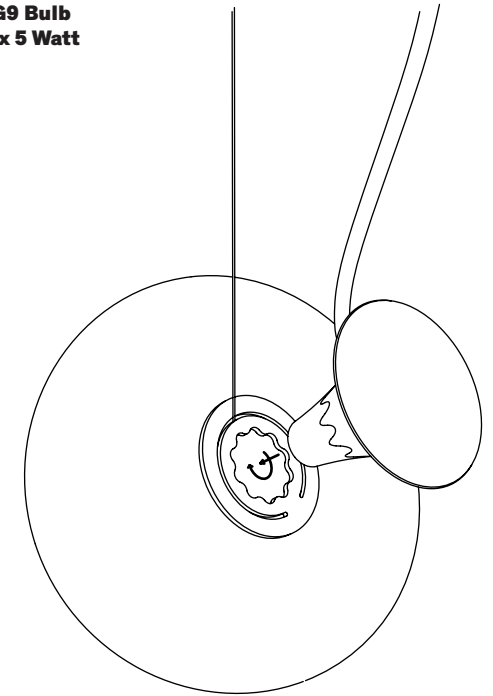

10

No ceiling system is
included with this lamp,
due to various
installation options.

Option A : Ceiling Rose

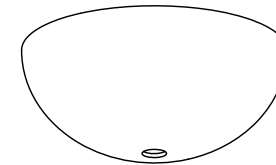

Option B : Ceiling Split X 5



Please visit Nordic-Tales.com for more
information about your options.